

ZENSTAR

Quality Tooling Redefined

Complete range of Dies & Die Nuts

- BSW, UNC, UNF & BSF
- BSP, BSPT & NPT
- BSB, ME & BA
- METRIC, COARSE AND FINE PITCH

CATALOGUE - 2023

S

E

D

D

HSS External Threading Round Dies & Hex Nuts



TECHNICAL DETAILS

DOS AND DONT'S - THREADING WITH DIES

- ❑ **Chamfer:** Make a chamfer at the end of the bar at an angle of 45 degrees to remove sudden loading of the leading edges. This has to be done before starting the die or die nut. Also it has to be made certain that the die or die nut is presented to the bolt squarely.
- ❑ **Tolerance:** Major diameter of the bolt usually has large tolerances. Use this to your advantage by reducing the diameter of the bar. Thus, the cutting force will be reduced to a minimum. If tolerance class is not specified, consider tolerance applicable for medium range i.e. 6H and 6G.
- ❑ **Swarf:** To direct the swarf away from cutting area, it is always preferable to use the gun nose type of die.
- ❑ **Lubricant:** The cutting area should always be supplied with a steady flow of the correct lubricant.
- ❑ **Split dies:** To avoid rubbing, the adjustable split die should not open out. Move the adjustable screws equally by say, 0.15 mm to close the split die. If it is done unequally, there may be pressure on one side which may lead to breakage.
- ❑ **Cleaning:** As a norm, die nuts are used for cleaning out existing threads. Usually the process is done by hand. Avoid using die nuts for thread cutting unless it is an exception.
- ❑ **Rake angle:** Large rake angle for long chip formation whereas a small rake angle for short chip formation. Its applicable and or workpiece material isn't specified, assume it as intermediate tensile strength.

ROUND DIES NOMENCLATURE

HEXAGONAL DIES NOMENCLATURE

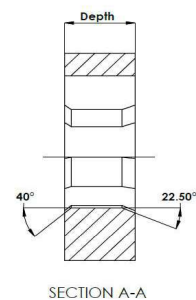
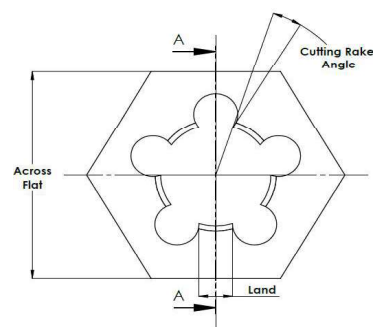
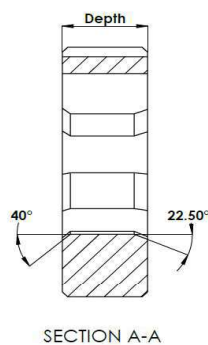
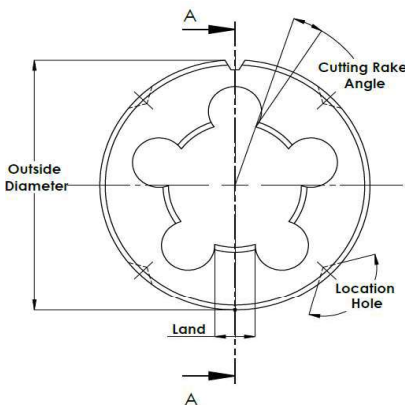

ADVANTAGES - LAPPING

Lapping is a process of fine removal of material using emery compound. In this process material removal is in Microns.

Thread Lapping on Round Dies are done primarily for bring thread closer to the required tolerance.

Close to 20 to 25 micron material is removed from the flank of the threads to achieve required tolerance.

Lapped Threads not only achieves tighter tolerance, but also produces superior quality threads on components, especially on soft material like Brass and Aluminium.

It also adds to the overall look of the Tool.

CONTENTS

ROUND SPLIT DIES

| Material | | Thread Form | Standard | Tolerance |
|----------|-----|-------------|----------|-----------|
| CS | HSS | M | BS1127 | 6G |
| CS | HSS | MF | BS1127 | 6G |
| CS | HSS | BSW | BS1127 | 6G |
| CS | HSS | BSF | BS1127 | 6G |
| CS | HSS | BA | BS1127 | 6G |
| CS | HSS | BSB | BS1127 | 6G |
| CS | HSS | ME | BS1127 | 6G |
| CS | HSS | WF | BS1127 | 6G |
| CS | HSS | BSP | BS1127 | 6G |
| CS | HSS | BSPT | BS1127 | 6G |
| CS | HSS | UNC | BS1127 | 2A |
| CS | HSS | UNF | BS1127 | 2A |

ROUND SOLID DIES

| Material | | Thread Form | Standard | Tolerance |
|----------|-----|-------------|----------|-----------|
| CS | HSS | NPT | BS1127 | 2A |
| CS | HSS | M | BS1127 | 6G |
| CS | HSS | MF | BS1127 | 6G |

HEXAGONAL DIES

| Material | | Thread Form | Standard | Tolerance |
|----------|-----|-------------|----------|-----------|
| CS | HSS | M | BS1127 | 6G |
| CS | HSS | MF | BS1127 | 6G |
| CS | HSS | BSW | BS1127 | 6G |
| CS | HSS | BSF | BS1127 | 6G |
| CS | HSS | BSP | BS1127 | 2A |
| CS | HSS | BSPT | BS1127 | 2A |
| CS | HSS | UNC | BS1127 | 2A |
| CS | HSS | UNF | BS1127 | 2A |
| CS | HSS | NPT | BS1127 | 2A |

Model Engineer Threads (ME)

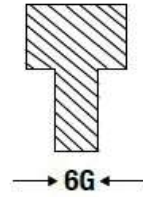
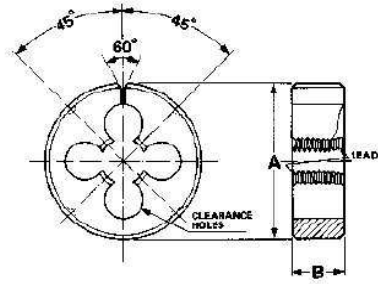

Unit : mm

| Nominal Diameter | TPI | Outer Diameter | Thickness | No. Clearance Hole | Threading Diameter |
|------------------|-----|----------------|-----------|--------------------|--------------------|
| Ø D | | A | B | | |
| 1/8" | 40 | 13/16" | 1/4" | 3 | 3.14 |
| 5/32" | 32 | 13/16" | 1/4" | 3 | 3.93 |
| 3/16" | 40 | 13/16" | 1/4" | 3 | 4.72 |
| 7/32" | 40 | 13/16" | 1/4" | 4 | 5.51 |
| 1/4" | 40 | 13/16" | 1/4" | 4 | 6.31 |
| 1/4" | 40 | 1" | 3/8" | 4 | 6.31 |
| 9/32" | 32 | 1" | 3/8" | 4 | 7.10 |
| 5/16" | 32 | 1" | 3/8" | 4 | 7.90 |
| 3/8" | 32 | 1" | 3/8" | 4 | 9.48 |

British Brass Threads (BSB)

| Nominal Diameter | TPI | Outer Diameter | Thickness | No. Clearance Hole | Threading Diameter |
|------------------|-----|----------------|-----------|--------------------|--------------------|
| Ø D | | A | B | | |
| 1/4" | 26 | 13/16" | 1/4" | 4 | 6.31 |
| 1/4" | 26 | 1" | 3/8" | 4 | 6.31 |
| 5/16" | 26 | 1" | 3/8" | 4 | 7.89 |
| 3/8" | 26 | 1" | 3/8" | 4 | 9.48 |
| 7/16" | 26 | 1.1/2" | 1/2" | 5 | 11.06 |
| 1/2" | 26 | 1.1/2" | 1/2" | 5 | 12.64 |
| 9/16" | 26 | 1.1/2" | 1/2" | 5 | 14.23 |
| 5/8" | 26 | 1.1/2" | 1/2" | 5 | 15.81 |
| 3/4" | 26 | 1.1/2" | 1/2" | 6 | 18.98 |

British Association Thread (BA)

| Nominal Diameter | TPI | Outer Diameter | Thickness | No. Clearance Hole | Threading Diameter |
|------------------|------|----------------|-----------|--------------------|--------------------|
| Ø D | | A | B | | |
| # 12 | 90.9 | 13/16" | 1/4" | 3 | 1.27 |
| # 11 | 81.9 | 13/16" | 1/4" | 3 | 1.47 |
| # 10 | 72.6 | 13/16" | 1/4" | 3 | 1.67 |
| # 9 | 65.1 | 13/16" | 1/4" | 3 | 1.87 |
| # 8 | 59.1 | 13/16" | 1/4" | 3 | 2.16 |
| # 7 | 52.9 | 13/16" | 1/4" | 3 | 2.46 |
| # 6 | 47.9 | 13/16" | 1/4" | 3 | 2.76 |
| # 5 | 43 | 13/16" | 1/4" | 3 | 3.15 |
| # 4 | 38.5 | 13/16" | 1/4" | 3 | 3.55 |
| # 3 | 34.8 | 13/16" | 1/4" | 3 | 4.04 |
| # 2 | 31.4 | 13/16" | 1/4" | 3 | 4.64 |
| # 1 | 28.2 | 13/16" | 1/4" | 4 | 5.23 |
| # 0 | 25.4 | 13/16" | 1/4" | 4 | 5.92 |

BSW / BSF / UNC / UNF THREADS

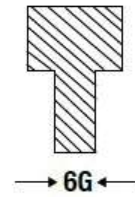
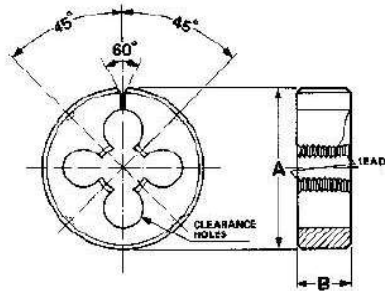

Unit : mm

| Nominal Diameter Ø D | TPI | | | | Outer Diameter A | Thickness B | No. Clearance Hole | Threading Diameter |
|-------------------------|-----|-----|-----|-----|---------------------|----------------|--------------------|--------------------|
| | BSW | BSF | UNC | UNF | | | | |
| 1/16" | 60 | | | | 13/16" | 1/4" | 3 | 1.56 |
| 3/32" | 48 | | | | 13/16" | 1/4" | 3 | 2.35 |
| 1/8" | 40 | | | | 13/16" | 1/4" | 3 | 3.14 |
| 5/32" | 32 | | | | 13/16" | 1/4" | 3 | 3.93 |
| 3/16" | 24 | 32 | | | 13/16" | 1/4" | 3 | 4.72 |
| 7/32" | 24 | 28 | | | 13/16" | 1/4" | 4 | 5.51 |
| 1/4" | 20 | 26 | 20 | 28 | 1" | 3/8" | 3 | 6.31 |
| 9/32" | 20 | 26 | | | 1" | 3/8" | 4 | 7.10 |
| 5/16" | 18 | 22 | 18 | 24 | 1" | 3/8" | 4 | 7.88 |
| 3/8" | 16 | 20 | 16 | 24 | 1" | 3/8" | 4 | 9.47 |
| 7/16" | 14 | 18 | 14 | 20 | 1.1/2" | 1/2" | 4 | 11.05 |
| 1/2" | 12 | 16 | 13 | 20 | 1.1/2" | 1/2" | 4 | 12.63 |
| 9/16" | 12 | 16 | 12 | 18 | 1.1/2" | 1/2" | 5 | 14.21 |
| 5/8" | 11 | 14 | 11 | 18 | 1.1/2" | 1/2" | 5 | 15.80 |
| 11/16" | 11 | | | | 1.1/2" | 1/2" | 6 | 17.39 |
| 3/4" | 10 | 12 | 10 | 16 | 1.1/2" | 1/2" | 6 | 18.97 |
| 7/8" | 9 | 11 | 9 | 14 | 2" | 5/8" | 5 | 22.14 |
| 1" | 8 | 10 | 8 | 12 | 2" | 5/8" | 6 | 25.30 |
| 1.1/8" | 7 | 9 | 7 | 12 | 2.1/4" | 11/16" | 6 | |
| 1.1/4" | 7 | 9 | 7 | 12 | 2.1/4" | 11/16" | 6 | |
| 1.3/8" | 6 | 8 | 6 | 12 | 65 mm | 7/8" | 6 | |
| 1.1/2" | 6 | 8 | 6 | 12 | 65 mm | 7/8" | 6 | |
| 1.1/2" | 6 | 8 | 6 | 12 | 65 mm | 7/8" | 6 | |
| 1.3/4" | 5 | 7 | 5 | 14 | 90 mm | 1" | 6 | |
| 2" | 4.5 | 7 | 5 | | 90 mm | 1" | 6 | |
| #3 | | | | 56 | 13/16" | 1/4" | 3 | 2.83 |
| #4 | | | 40 | 48 | 13/16" | 1/4" | 3 | 2.83 |
| #5 | | | 40 | 44 | 13/16" | 1/4" | 3 | 3.15 |
| #6 | | | 32 | 40 | 13/16" | 1/4" | 3 | 3.48 |
| #8 | | | 32 | 36 | 13/16" | 1/4" | 3 | 4.14 |
| #10 | | | 24 | 32 | 13/16" | 1/4" | 3 | 4.79 |
| #12 | | | 24 | 28 | 13/16" | 1/4" | 4 | 5.45 |

Metric Coarse Threads

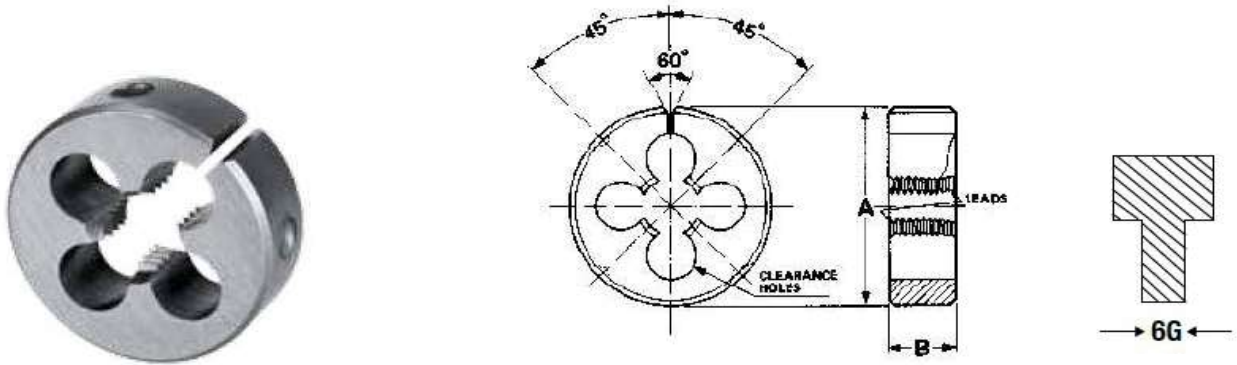

Unit : mm

| Nominal Diameter | TPI | Outer Diameter | Thickness | No. Clearance Hole | Threading Diameter |
|------------------|------|----------------|-----------|--------------------|--------------------|
| Ø D | | A | B | | |
| M2.0 | 0.40 | 13/16" | 1/4" | 3 | 1.96 |
| M2.2 | 0.45 | 13/16" | 1/4" | 3 | 1.96 |
| M2.3 | 0.40 | 13/16" | 1/4" | 3 | 1.96 |
| M2.5 | 0.45 | 13/16" | 1/4" | 3 | 1.96 |
| M3 | 0.50 | 13/16" | 1/4" | 3 | 2.95 |
| M3.5 | 0.60 | 13/16" | 1/4" | 3 | 2.95 |
| M4 | 0.70 | 13/16" | 1/4" | 3 | 3.95 |
| M4.5 | 0.75 | 13/16" | 1/4" | 3 | 3.95 |
| M5 | 0.80 | 13/16" | 1/4" | 3 | 4.95 |
| M6 | 1.00 | 13/16" | 1/4" | 4 | 5.93 |
| M7 | 1.00 | 13/16" | 1/4" | 4 | 6.93 |
| M8 | 1.25 | 1" | 3/8" | 4 | 7.92 |
| M9 | 1.24 | 1" | 3/8" | 4 | 8.93 |
| M10 | 1.50 | 1" | 3/8" | 4 | 9.91 |
| M12 | 1.75 | 1.1/2" | 1/2" | 4 | 11.90 |
| M14 | 2.00 | 1.1/2" | 1/2" | 5 | 13.89 |
| M16 | 2.00 | 1.1/2" | 1/2" | 5 | 15.89 |
| M18 | 2.50 | 1.1/2" | 1/2" | 6 | 17.88 |
| M20 | 2.50 | 2" | 5/8" | 5 | 19.88 |
| M22 | 2.50 | 2" | 5/8" | 5 | 21.88 |
| M24 | 3.00 | 2" | 5/8" | 5 | 23.88 |
| M25 | 3.00 | 2.1/4" | 11/16" | 6 | 23.88 |
| M27 | 3.00 | 2.1/4" | 11/16" | 6 | |
| M30 | 3.50 | 2.1/4" | 11/16" | 6 | |
| M33 | 3.50 | 2.1/4" | 11/16" | 6 | |
| M36 | 4.00 | 75 mm | 7/8" | 6 | |
| M39 | 4.00 | 75 mm | 7/8" | 6 | |
| M42 | 4.50 | 75 mm | 7/8" | 6 | |
| M45 | 4.50 | 75 mm | 7/8" | 6 | |
| M48 | 5.00 | 90 mm | 1" | 6 | |

Metric Fine Threads

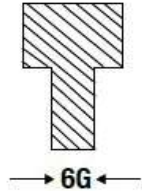
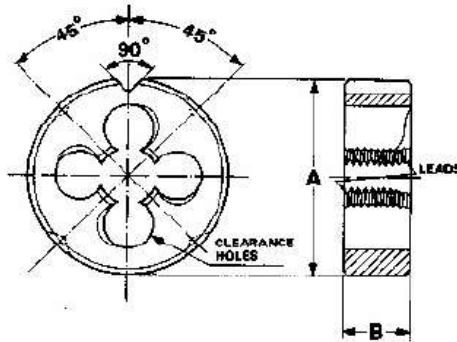

Unit : mm

| Nominal Diameter | TPI | Outer Diameter | Thickness | No. Clearance Hole | Threading Diameter |
|------------------|------|----------------|-----------|--------------------|--------------------|
| Ø D | | A | B | | |
| M3.0 | 0.35 | 13/16" | 1/4" | 3 | 2.96 |
| M3.5 | 0.35 | 13/16" | 1/4" | 3 | 3.46 |
| M4 | 0.50 | 13/16" | 1/4" | 3 | 3.95 |
| M4.5 | 0.50 | 13/16" | 1/4" | 3 | 4.45 |
| M5 | 0.50 | 13/16" | 1/4" | 3 | 4.95 |
| M6 | 0.75 | 13/16" | 1/4" | 4 | 5.95 |
| M7 | 0.75 | 1" | 1/4" | 4 | 6.95 |
| M8 | 0.75 | 1" | 3/8" | 4 | 7.97 |
| M8 | 1.00 | 1" | 3/8" | 4 | 7.93 |
| M9 | 1.00 | 1" | 3/8" | 4 | 8.95 |
| M10 | 1.00 | 1" | 3/8" | 4 | 9.93 |
| M10 | 1.25 | 1" | 3/8" | 4 | 9.95 |
| M12 | 1.00 | 1.1/2" | 1/2" | 5 | 11.93 |
| M12 | 1.25 | 1.1/2" | 1/2" | 5 | 11.92 |
| M12 | 1.50 | 1.1/2" | 1/2" | 4 | 11.91 |
| M14 | 1.00 | 1.1/2" | 1/2" | 5 | 13.93 |
| M14 | 1.25 | 1.1/2" | 1/2" | 5 | 13.92 |
| M14 | 1.50 | 1.1/2" | 1/2" | 5 | 13.91 |
| M16 | 1.00 | 1.1/2" | 1/2" | 5 | 15.93 |
| M16 | 1.50 | 1.1/2" | 1/2" | 5 | 15.91 |
| M18 | 1.00 | 1.1/2" | 1/2" | 6 | 17.91 |
| M18 | 1.50 | 1.1/2" | 1/2" | 6 | 17.91 |
| M18 | 2.00 | 1.1/2" | 1/2" | 6 | 17.91 |
| M20 | 1.50 | 2" | 1/2" | 6 | 19.91 |
| M20 | 2.00 | 2" | 5/8" | 5 | 19.91 |
| M22 | 1.50 | 2" | 5/8" | 6 | 21.91 |
| M22 | 2.00 | 2" | 5/8" | 6 | 21.91 |
| M24 | 1.50 | 2" | 5/8" | 6 | 23.93 |
| M24 | 2.00 | 2" | 5/8" | 6 | 23.9 |

Metric Fine Threads

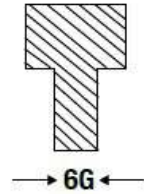
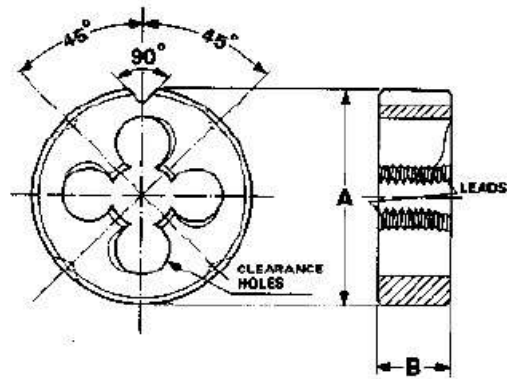

Unit : mm

| Nominal Diameter | TPI | Outer Diameter | Thickness | No. Clearance Hole | Threading Diameter |
|------------------|------|----------------|-----------|--------------------|--------------------|
| Ø D | | A | B | | |
| M25 | 1.50 | 2.1/4" | 5/8" | 6 | 24.91 |
| M25 | 2.00 | 2.1/4" | 5/8" | 6 | 24.91 |
| M26 | 1.50 | 2.1/4" | 5/8" | 6 | 25.9 |
| M26 | 2.00 | 2.1/4" | 5/8" | 6 | 25.9 |
| M27 | 1.50 | 2.1/4" | 5/8" | 6+6 | 26.9 |
| M27 | 2.00 | 2.1/4" | 5/8" | 6+6 | 26.9 |
| M28 | 1.50 | 2.1/4" | 5/8" | 6+6 | 27.9 |
| M28 | 2.00 | 2.1/4" | 5/8" | 6+6 | 27.9 |
| M30 | 1.50 | 2.1/4" | 5/8" | 6+6 | 29.9 |
| M30 | 2.00 | 2.1/4" | 5/8" | 6+6 | 29.9 |
| M30 | 3.00 | 2.1/4" | 5/8" | 6+6 | 29.9 |
| M32 | 1.50 | 2.1/4" | 11/16" | 6+6 | |
| M32 | 2.00 | 2.1/4" | 11/16" | 6+6 | |
| M33 | 1.50 | 2.1/4" | 11/16" | 6+6 | |
| M33 | 2.00 | 2.1/4" | 11/16" | 6+6 | |
| M33 | 3.00 | 2.1/4" | 11/16" | 6+6 | |
| M35 | 1.50 | 2.1/4" | 7/8" | 6 | |
| M36 | 1.50 | 75 mm | 7/8" | 6 | |
| M36 | 2.00 | 75 mm | 7/8" | 6 | |
| M36 | 3.00 | 75 mm | 7/8" | 6 | |
| M39 | 1.50 | 75 mm | 7/8" | 6 | |
| M39 | 2.00 | 75 mm | 7/8" | 6 | |
| M39 | 3.00 | 75 mm | 7/8" | 6 | |
| M42 | 1.50 | 75 mm | 7/8" | 6 | |
| M42 | 2.00 | 75 mm | 7/8" | 6 | |
| M42 | 3.00 | 75 mm | 7/8" | 6 | |
| M42 | 4.00 | 75 mm | 7/8" | 6 | |
| M45 | 1.50 | 75 mm | 7/8" | 6 | |
| M45 | 2.00 | 75 mm | 7/8" | 6 | |
| M45 | 3.00 | 75 mm | 7/8" | 6 | |
| M45 | 4.00 | 75 mm | 7/8" | 6 | |
| M48 | 1.50 | 90 mm | 1" | 6 | |
| M48 | 2.00 | 90 mm | 1" | 6 | |
| M48 | 3.00 | 90 mm | 1" | 6 | |
| M48 | 4.00 | 90 mm | 1" | 6 | |

BSP / NPT / BSPT Threads

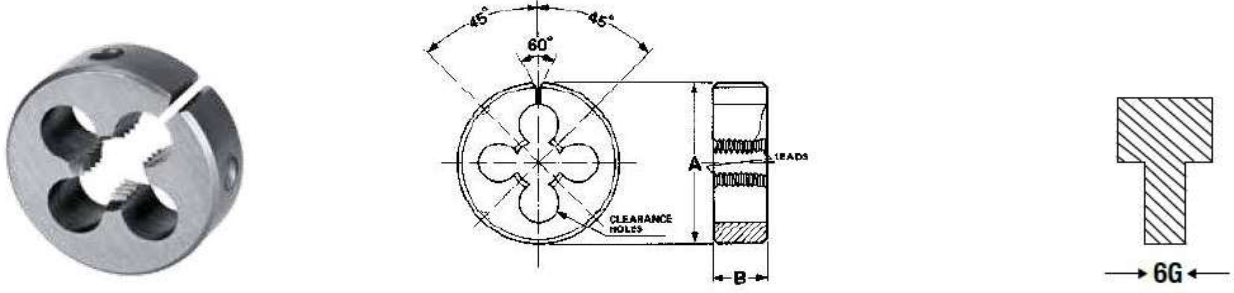

Unit : mm

| Nominal Diameter Ø D | TPI | | | Outer Diameter A | Thickness | | No. Clearance Hole | Threading Diameter |
|-------------------------|-----|--------|------|---------------------|-----------|----------|--------------------|--------------------|
| | BSP | NPT | BSPT | | BSP | BSPT/NPT | | |
| 1/8" | 28 | 27 | 28 | 1" | 3/8" | 10 | 4 | 9.68 |
| 1/4" | 19 | 18 | 19 | 1.1/2" | 1/2" | 14 | 5 | 13.11 |
| 3/8" | 19 | 18 | 19 | 1.1/2" | 1/2" | 14 | 5 | 16.6 |
| 1/2" | 14 | 14 | 14 | 2" | 5/8" | 19 | 6 | 20.89 |
| 5/8" | 14 | | | 2" | 5/8" | | 6 | 22.84 |
| 3/4" | 14 | 14 | 14 | 2" | 5/8" | 20 | 6 | 26.36 |
| 7/8" | 14 | | | 2.1/4" | 5/8" | | 6+6 | 30.11 |
| 1" | 11 | 11.1/2 | 11 | 2.1/4" | 5/8" | 25 | 6+6 | 33.16 |
| 1.1/8" | 11 | | | 75 mm | 7/8" | | 6 | |
| 1.1/4" | 11 | 11.1/2 | 11 | 75 mm | 7/8" | 25 | 6 | |
| 1.3/8" | 11 | | | 90 mm | 1" | | | |
| 1.1/2" | 11 | 11.1/2 | 11 | 90 mm | 1" | 25 | 6 | |

HSS HEXAGONAL DIES

BSP / NPT / BSPT Threads

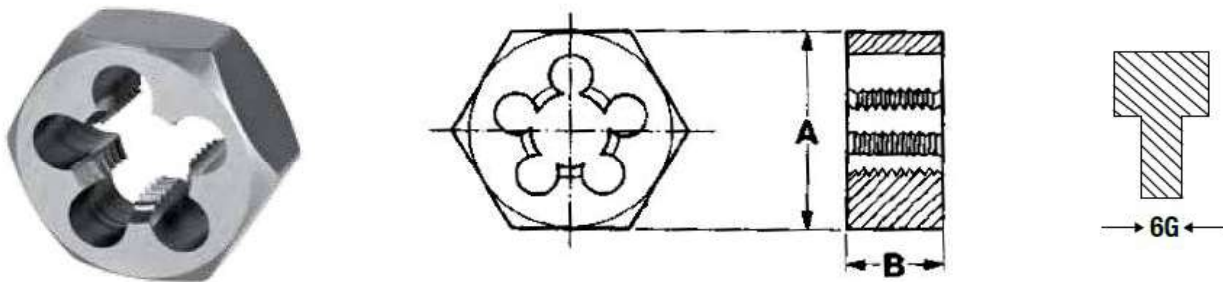

Unit : mm

| Nominal Diameter Ø D | TPI | | | Across Flat A | Thickness |
|-------------------------|-----|--------|------|------------------|-----------|
| | BSP | NPT | BSPT | | |
| 1/8" | 28 | 27 | 28 | 0.920" | 10 |
| 1/4" | 19 | 18 | 19 | 1.100" | 14 |
| 3/8" | 19 | 18 | 19 | 1.300" | 14 |
| 1/2" | 14 | 14 | 14 | 1.670" | 19 |
| 3/4" | 14 | 14 | 14 | 2.050" | 20 |
| 1" | 11 | 11.1/2 | 11 | 2.580" | 25 |
| 1.1/2" | 11 | 11.1/2 | 11 | 3.150" | |
| 2" | 11 | 11.1/2 | 11 | 3.890" | |

BSW / BSF / UNC / UNF Threads

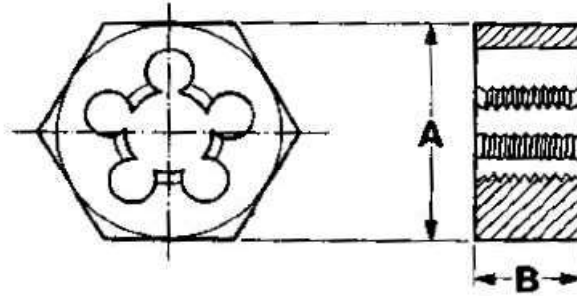

Unit : mm

| Nominal Diameter | TPI | | | | Across Flat | Thickness |
|------------------|-----|-----|-----|-----|-------------|-------------|
| | BSW | BSF | UNC | UNF | A | |
| Ø D | | | | | | |
| 1/8" | 40 | | | | 0.710" | 6.35 |
| 5/32" | 32 | | | | 0.710" | 6.35 |
| 3/16" | 24 | 32 | | | 0.710" | 6.35 |
| 7/32" | 24 | 28 | | | 0.710" | 6.35 |
| 1/4" | 20 | 26 | 20 | 28 | 0.710" | 6.35 |
| 9/32" | 20 | 26 | | | 0.820" | 7.94 |
| 5/16" | 18 | 22 | 18 | 24 | 0.820" | 7.94 |
| 3/8" | 16 | 20 | 16 | 24 | 0.920" | 9.53 |
| 7/16" | 14 | 18 | 14 | 20 | 1.010" | 11.11 |
| 1/2" | 12 | 16 | 13 | 20 | 1.100" | 12.7 |
| 9/16" | 12 | 16 | 12 | 18 | 1.300" | 15.88 |
| 5/8" | 11 | 14 | 11 | 18 | 1.300" | 15.88 |
| 3/4" | 10 | 12 | 10 | 16 | 1.480" | 17.46 |
| 7/8" | 9 | 11 | 9 | 14 | 1.670" | 20.63 |
| 1" | 8 | 10 | 8 | 12 | 2.050" | 23.81 |
| 1.1/8" | 7 | 9 | 7 | 12 | 2.220" | 26.99 |
| 1.1/4" | 7 | 9 | 7 | 12 | 2.220" | 26.99 |
| 1.3/8" | 6 | 8 | 6 | 12 | 2.580" | 28.58 |
| 1.1/2" | 6 | 8 | 6 | 12 | 2.760" | 31.75 |
| 1.3/4" | 5 | 7 | 5 | 14 | 3.150" | 31.75/44.45 |
| 2" | 5 | 7 | 5 | | 3.550" | 31.75/44.45 |
| #5 | | | 40 | 44 | 0.710" | 6.35 |
| #6 | | | 32 | 40 | 0.710" | 6.35 |
| #8 | | | 32 | 36 | 0.710" | 6.35 |
| #10 | | | 24 | 32 | 0.710" | 6.35 |
| #12 | | | 24 | 28 | 0.710" | 6.35 |

Metric Coarse Threads

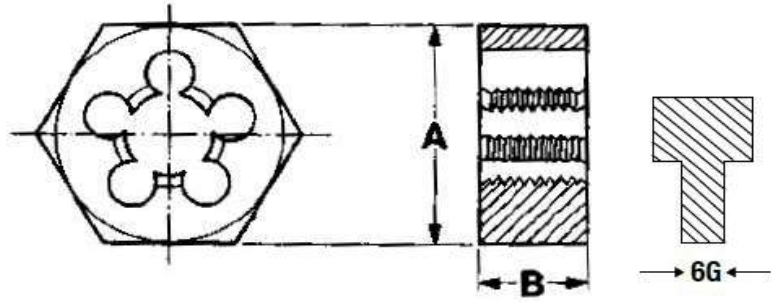

Unit : mm

| Nominal Diameter | TPI | Across Flat | Thickness |
|------------------|------|-------------|-----------|
| Ø D | | A | |
| M3 | 0.50 | 0.710" | 6.35 |
| M3.5 | 0.60 | 0.710" | 6.35 |
| M4 | 0.70 | 0.710" | 6.35 |
| M4.5 | 0.75 | 0.710" | 6.35 |
| M5 | 0.80 | 0.710" | 6.35 |
| M6 | 1.00 | 0.710" | 6.35 |
| M7 | 1.00 | 0.710" | 6.35 |
| M8 | 1.25 | 0.820" | 7.94 |
| M9 | 1.24 | 0.920" | 9.53 |
| M10 | 1.50 | 0.920" | 9.53 |
| M11 | 2.00 | 1.010" | 11.11 |
| M12 | 1.75 | 1.100" | 12.7 |
| M14 | 2.00 | 1.300" | 15.88 |
| M16 | 2.00 | 1.300" | 15.88 |
| M18 | 2.50 | 1.480" | 17.46 |
| M20 | 2.50 | 1.480" | 17.46 |
| M22 | 2.50 | 1.670" | 20.63 |
| M24 | 3.00 | 2.050" | 23.81 |
| M25 | 3.00 | 2.220" | 26.99 |
| M27 | 3.00 | 2.220" | 26.99 |
| M30 | 3.50 | 2.220" | 26.99 |
| M32 | 2.00 | 2.220" | 26.99 |
| M33 | 3.50 | 2.580" | 28.5 |
| M36 | 4.00 | 2.580" | 28.5 |
| M39 | 4.00 | 2.580" | 28.5 |
| M42 | 4.50 | 2.580" | 28.5 |

*“Products are made in the factory,
but brands are created in the mind”*



TECHNO TOOLS IMPEX



ZENSTAR

Quality Tooling Redefined

ROTOZEN

www.zenstarproducts.com
email sales@zenstarproducts.com

www.rotozenproducts.com
email : sales@rotozenproducts.com

Ground Floor, Unit No. 6, Aman Chambers, Opera House, Mumbai - 400 004. INDIA
Tel. : 95793 09659